

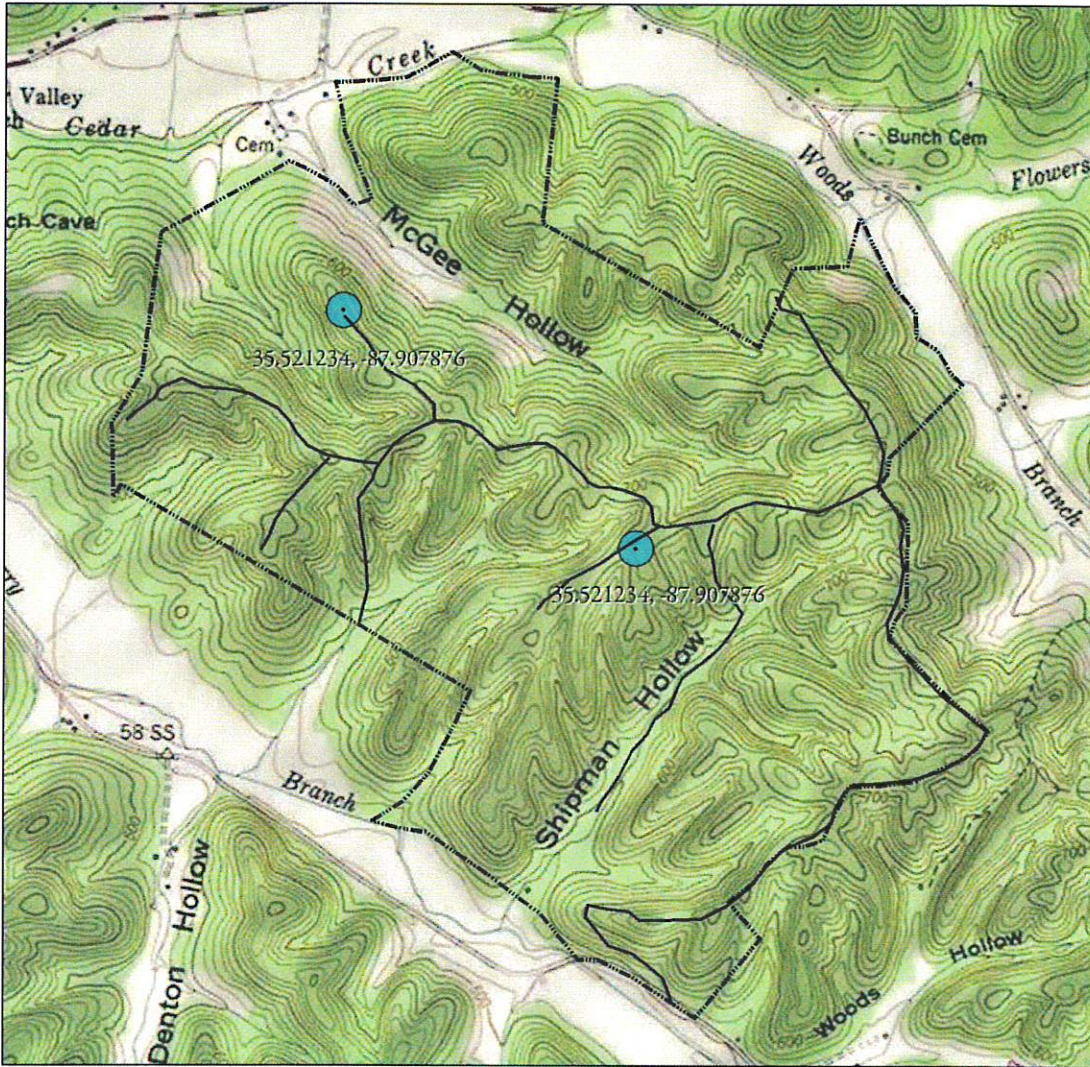

HOUSE SITE DRAWING



**Little Cedar Creek Conservation Easement
Perry County, Tennessee
Building Envelopes, Two Acres, Two Sites**

- Center Point
-  Building Envelope
-  Access Roads

This map was created by Helia Environmental LLC for reference purposes only. The conservation easement boundary depicted herein is a representation and is not an actual easement boundary survey. It was compiled from the most authentic information available and is believed to be accurate. Helia Environmental is not responsible for any errors or omissions contained herein.

Preparer: Lloyd Raleigh on December 13, 2017

Source: USGS

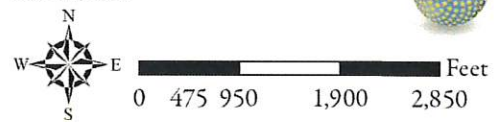

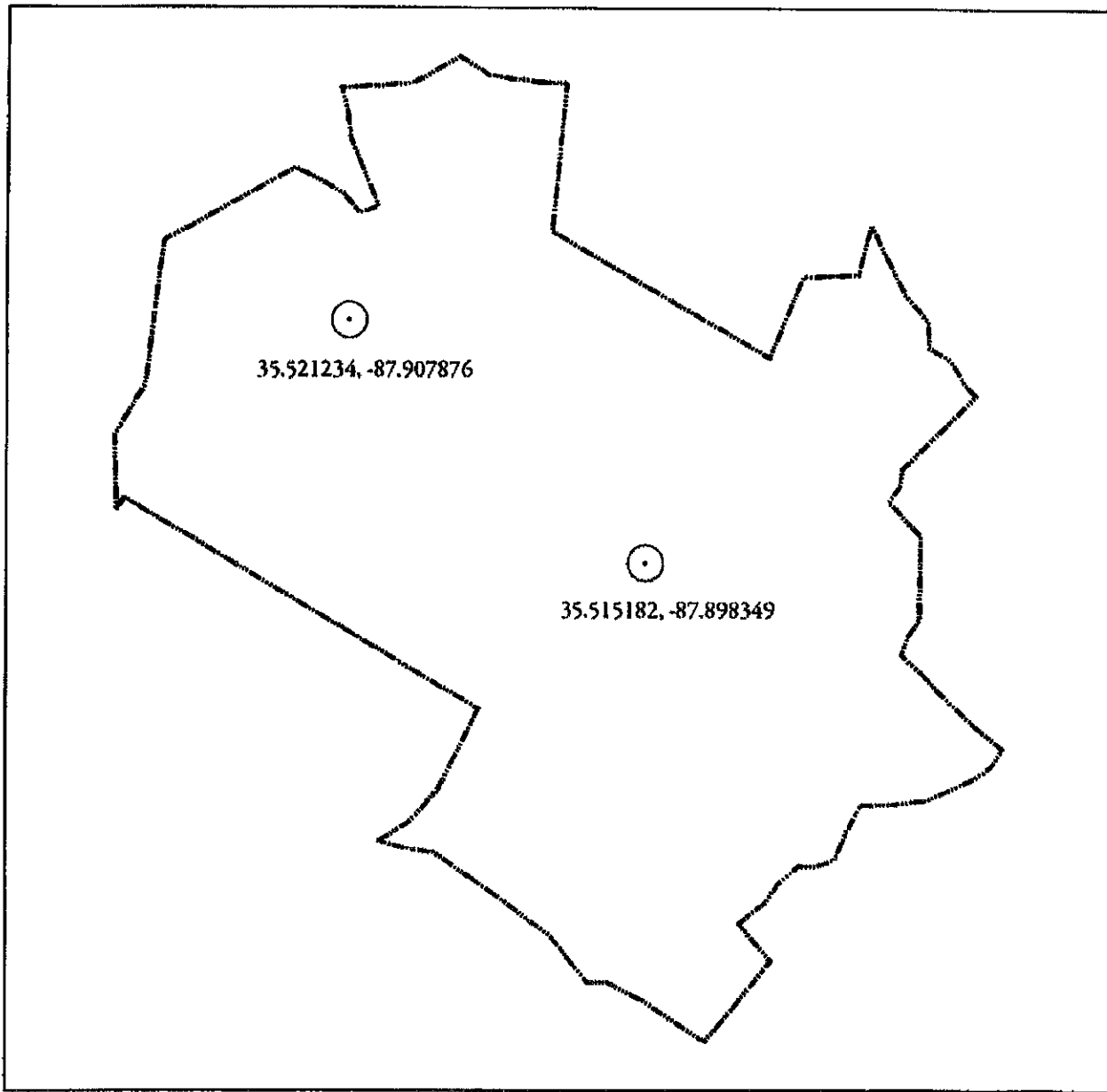

**Little Cedar Creek Conservation Easement
 Perry County, Tennessee
 Building Envelopes, Two Acres, Two Sites**

- Center Point
-  Building Envelope

This map was created by Helia Environmental LLC for reference purposes only. The conservation easement boundary depicted herein is a representation and is not an actual easement boundary survey. It was compiled from the most authentic information available and is believed to be accurate. Helia Environmental is not responsible for any errors or omissions contained hereon.
 Preparer: Lloyd Raleigh on December 15, 2017

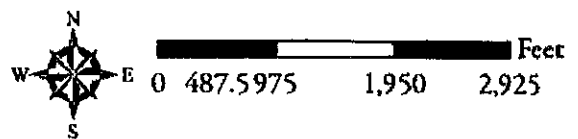

EXHIBIT C

Little Cedar Stands, LLC Legal Description of Homesites

Homesite1:

TO FIND THE POINT OF BEGINNING, start at the centerpoint of a circular tract, such centerpoint having coordinates of Latitude $35^{\circ}31'16.4424''$ (35.521234) North and Longitude $87^{\circ}54'28.3536''$ (87.907876) West, thence Due North for a distance of 166.53' to a calculated point in the circumference of said circular tract, the **POINT OF BEGINNING**, thence from said POB with the edge of said circle, in a clockwise direction, a circle having a circumference of 1,046.34' to the said Point of Beginning, said circular tract having an area of approximately 2.0 acres.

Homesite2:

TO FIND THE POINT OF BEGINNING, start at the centerpoint of a circular tract, such centerpoint having coordinates of Latitude $35^{\circ}30'54.6552''$ (35.515182) North and Longitude $87^{\circ}53'54.0564''$ (87.898349) West, thence Due North for a distance of 166.53' to a calculated point in the circumference of said circular tract, the **POINT OF BEGINNING**, thence from said POB with the edge of said circle, in a clockwise direction, a circle having a circumference of 1,046.34' to the said Point of Beginning, said circular tract having an area of approximately 2.0 acres.